

126

Fig. 1. THE ASCLEPION AT CORINTH
This is the kind of idol temple with which the Corinthians would be familiar. Notice the dining rooms.

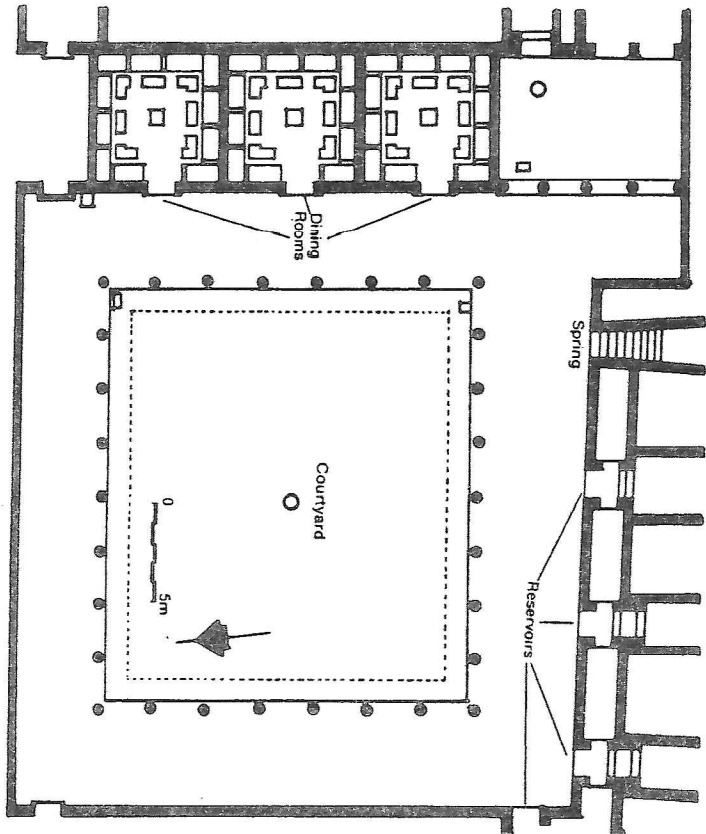

Fig. 2. THE DINING ROOMS OF THE ASCLEPION
Each of the three rooms could take eleven diners. Cooking was apparently done in the square space in the centre of the room. The courtyard formed a 'perfect little piazza' which could be used by anyone and which gave access to the dining rooms (cf. 8:10). It is not completely certain that these actual rooms were in use in the time of Paul, though it is probable. In any case there would have been a similar arrangement in the temples of his day generally.

127

TNTC
LEON MORRIS